

Logikub - planseu autoportant Premium

Basement ceiling

Thermal protection

$U = 0,20 \text{ W/(m}^2\text{K)}$

EnEV Bestand*: $U < 0,3 \text{ W/(m}^2\text{K)}$



Moisture proofing

Drying reserve: $1489 \text{ g/m}^2\text{a}$
No condensate



Heat protection

Temperature amplitude damping: 11
phase shift: 8,2 h
Thermal capacity inside: $33 \text{ kJ/m}^2\text{K}$

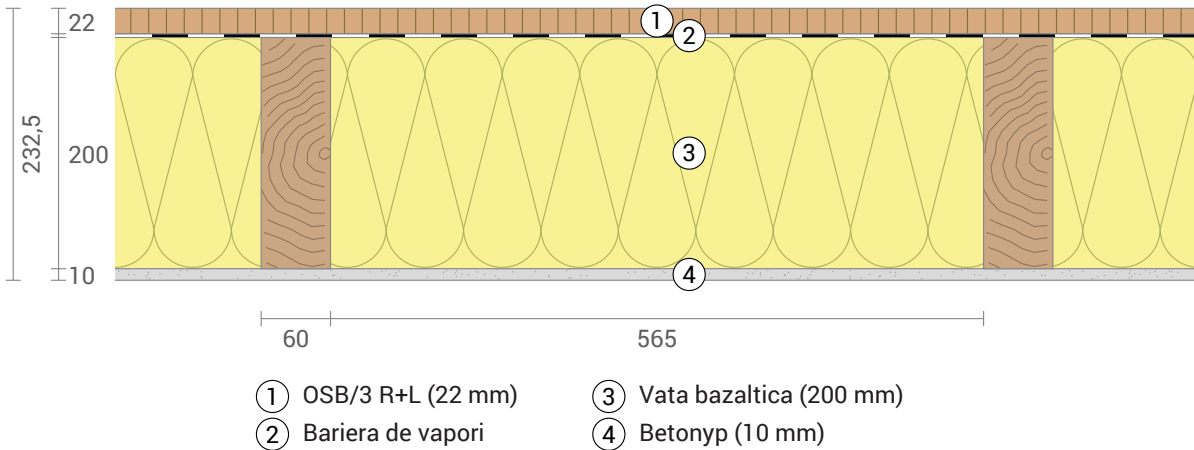
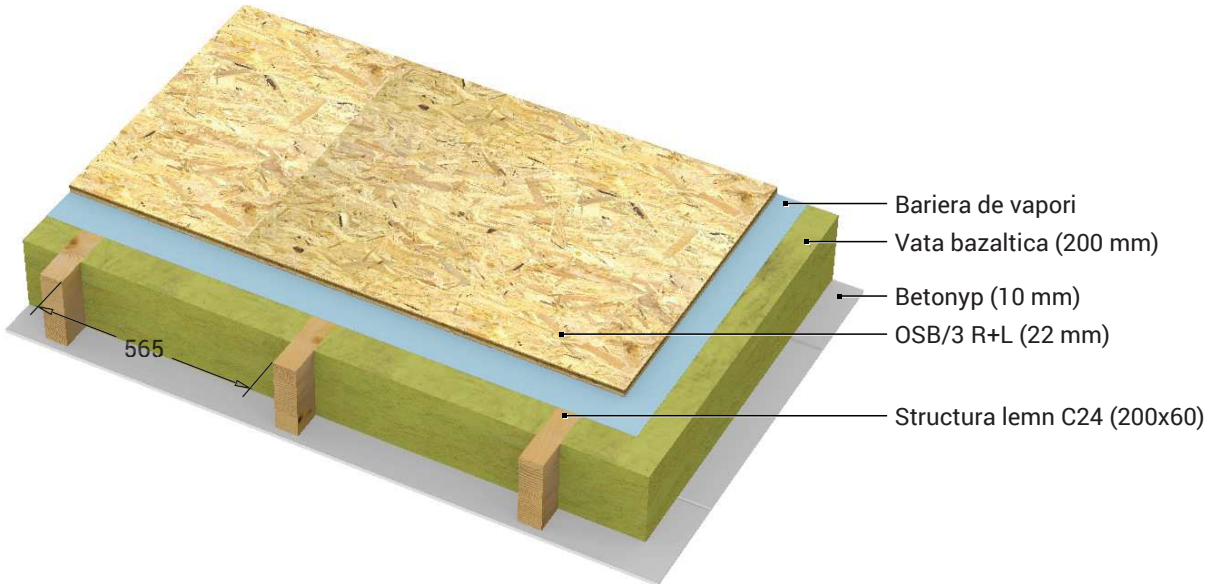

Inside air : $20,0^\circ\text{C} / 50\%$
Non-heated room: $-5,0^\circ\text{C} / 80\%$
Surface temperature.: $17,9^\circ\text{C} / -4,8^\circ\text{C}$

sd-value: $94,6 \text{ m}$
Drying reserve: $1489 \text{ g/m}^2\text{a}$

Thickness: $23,2 \text{ cm}$
Weight: 43 kg/m^2
Heat capacity: $56 \text{ kJ/m}^2\text{K}$

- EnEV Bestand BEG Einzelmaßn. GEG 2020/24 Bestand GEG 2023/24 Neubau